



24 Ashford Road, Sheffield, S11 8XZ

Saxton Mee

24 Ashford Road

Guide Price

£300,000

GUIDE PRICE: £300,000-£325,000

This lovely three bedroom terrace home is set in the highly sought after Sharrow Vale area, just a short walk from the vibrant independent shops, cafes and restaurants, as well as the popular Ecclesall Road.

Inside, the property offers a modern fitted kitchen with good workspace and storage, along with a comfortable living room that creates a warm and relaxed setting.

On the first floor there are two well proportioned bedrooms and a bright family bathroom. The second floor is home to a fantastic attic bedroom that feels spacious and full of character.

To the rear of the house is a lovely garden with a small outhouse that provides useful extra storage or potential for a little workshop area.

This is a welcoming home in a great location, ideal for anyone looking to enjoy the community feel and convenience of this popular part of Sheffield.

- located in the highly sought after Sharrow Vale area close to independent shops, cafes and restaurants
- Lovely three bedroom terrace home
- Modern fitted kitchen with good workspace and storage
- Comfortable living room with a relaxed and welcoming feel
- Two well proportioned bedrooms on the first floor
- Spacious attic bedroom on the top floor with plenty of character
- Attractive rear garden with a useful outhouse for storage or a small workshop







Ground Floor

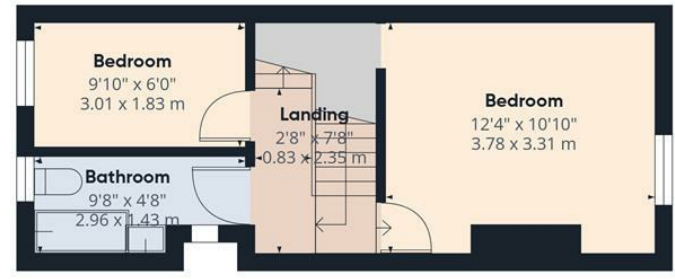

Floor 1



Floor 2



Approximate total area⁽¹⁾
785 ft²
72.9 m²

Reduced headroom
31 ft²
2.9 m²

(1) Excluding balconies and terraces.

Reduced headroom
..... Below 5 ft/1.5 m

Calculations reference the RICS IPMS 3C standard. Measurements are approximate and not to scale. This floor plan is intended for illustration only.

GIRAFFE360

While we endeavour to make our sales particulars fair, accurate and reliable, they are only a general guide to the property and, accordingly, if there is any point, which is of particular importance to you, please contact the relevant office. The Agents have not tested any apparatus, equipment, fittings or services and so cannot verify they are in working order. The buyer is advised to obtain verification. Please note all the measurement details are approximate and should not be relied upon as exact. All plans, floor plans and maps are for guidance purposes only and are not to scale. Under no circumstances should they be relied upon as exact or for use in planning carpets and other such fixtures, fittings or furnishings. YOUR HOME IS AT RISK IF YOU DO NOT KEEP UP REPAYMENTS ON A MORTGAGE OR OTHER LOAN SECURED ON IT. 'A Life Assurance policy may be requested.' 'Written Quotations of credit terms available on request.'

Banner Cross
T: 0114 268 3241
E: bannercross@saxtonmee.co.uk
www.saxtonmee.co.uk

Hathersage
T: 01433 650009
E: hathersage@saxtonmee.co.uk

Bakewell
T: 01629 815307
E: bakewell@saxtonmee.co.uk

Matlock
T: 01629 828250
E: matlock@saxtonmee.co.uk

